

# 3737 WESTOWN PARKWAY, WEST DES MOINES, IA 50266

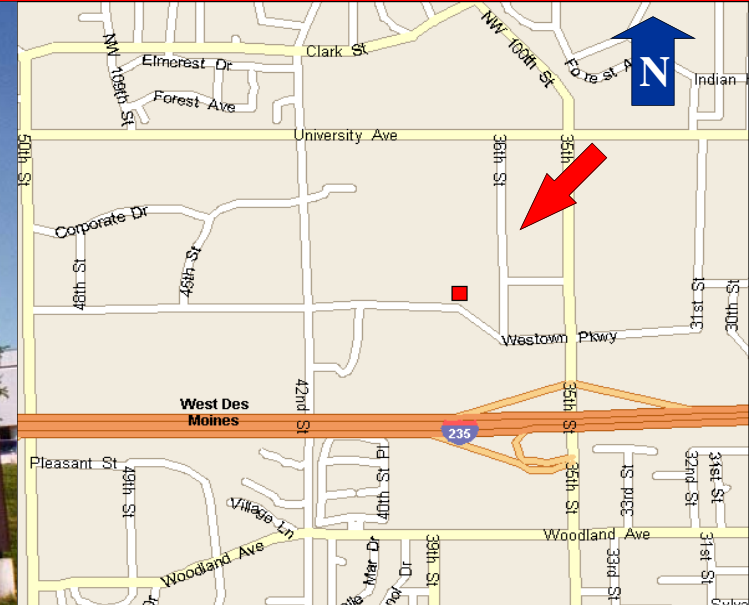

## The CUNA Building

## Lease Rate: \$16.00/SF Full Service

- Three story office building
- 1,028-9,997 square feet available
- Break room facility available to tenants.
- Excellent West Des Moines location with easy access to I-235/I-80 and frontage on Westtown Parkway.

- Upper Level: 2A- 5,406 SF  
2B- 1,028 SF  
2E- 9,997 SF
- Additional Information  
Year Built: 1983-1987  
Total Rentable Area: 79,484 SF  
Load Factor: 1.145  
Land Area: 5.07 Acres  
Loading Area: Dock receiving Area w/leveler

**Brad Hickok, CPM** 515-453-5446  
**Jason Lozano** 515-453-5471

3501 Westtown Parkway  
West Des Moines, Iowa 50266  
Phone 515-222-0000 Fax 515-453-5430

bhickok@iowarealtycommercial.com  
jlozano@iowarealtycommercial.com

**IOWA**Realty  
**COMMERCIAL**

[IowaRealtyCommercial.com](http://IowaRealtyCommercial.com)

